

PALMERHOUSE

A HILTON® HOTEL

Complimentary Wi-Fi will be available in the SSSP meeting space by using these case sensitive credentials:

- Network: Hilton Honors Meeting
- Password: SSSP2025

Map Key:



Elevators*



All-Gender Restrooms**



Restrooms

Restaurants:

- Lockwood Restaurant (Lobby Level)
- Lockwood Lobby Bar (Lobby Level)
- Lockwood Express and Express-2-You pick-up or room delivery (Lobby Level)
- Potter's Restaurant (Lobby Level)***

FIFTH FLOOR

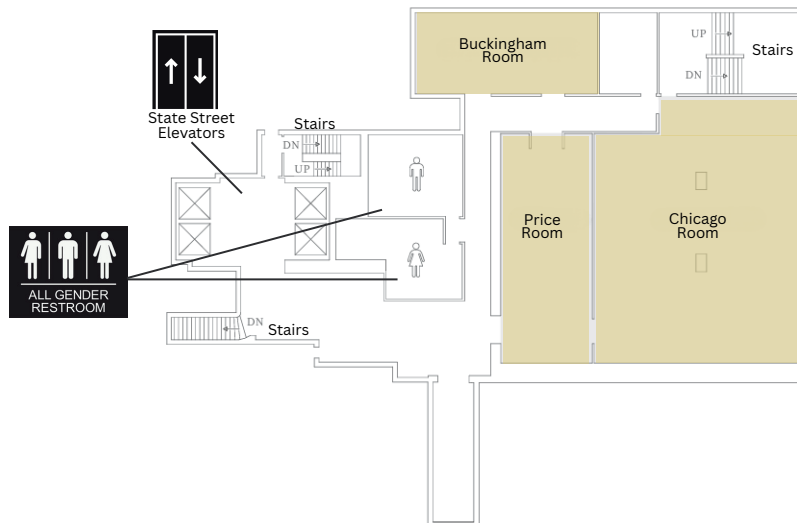

THIRD FLOOR

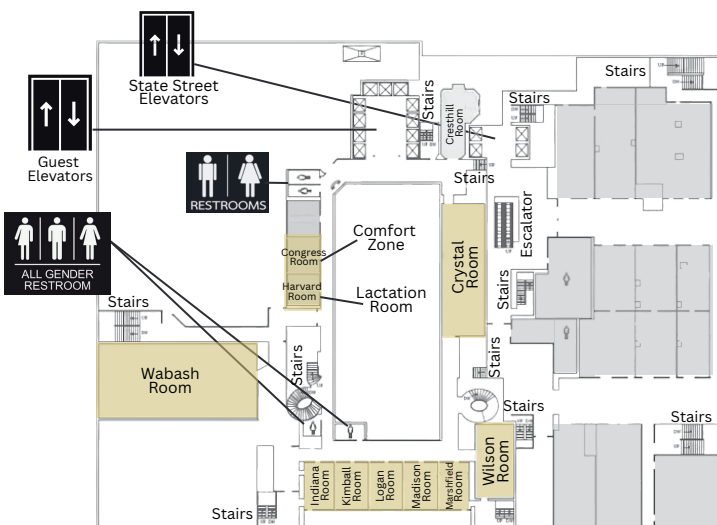

SIXTH FLOOR

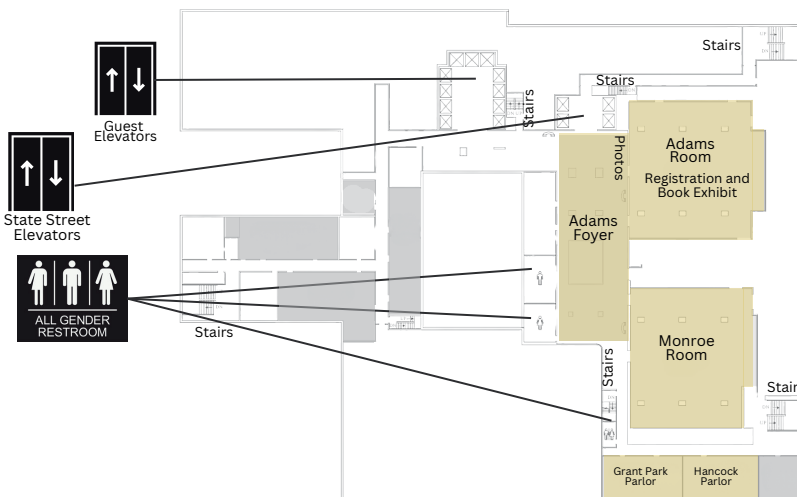

***Elevator directions to the conference spaces:** To access the 3rd and 6th floors, attendees may use the guest elevator banks. To access the 5th floor, use the guest elevators to access the 6th floor. Then, turn left when exiting the elevator bank to access the State Street elevators. Use the State Street elevators to access the 5th floor. You may also use the State Street elevators to access the 3rd, 5th, and 6th floors from the street level. If accessing the 3rd floor from the State Street elevators, please note that there is a set of stairs to access the conference space on the 3rd floor.

****The restrooms marked all gender above are available as follows:** The 3rd floor Friday-Sunday; the 5th floor Thursday-Monday; the 6th floor Thursday-Saturday. There is a permanent one-person, all-gender restroom located on the 6th floor near Grant Park Parlor. Men's restrooms and women's restrooms are located on the 3rd floor.

*****The Student Social Hour** is in the Potter's Restaurant in a private section.